

FÖCKERSPERGER

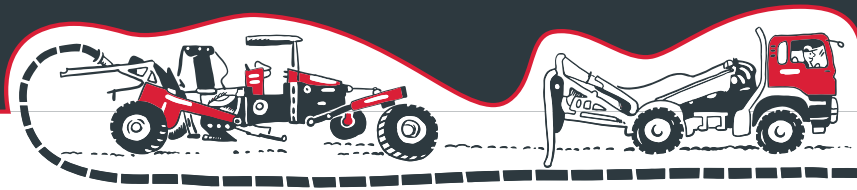

YOUR FIRST ADDRESS FOR

PIPE AND CABLE PLOW SYSTEMS



**MADE IN GERMANY
MADE BY FÖCKERSPERGER**

● **ECONOMICAL**

● **ECO-FRIENDLY**

● **POWERFUL**



TRADITION. INNOVATION. FÖCKERSPERGER.

VIPER V225 – FLEXIBLE AND POWERFUL

Surface protecting vibratory plow

With the new vibratory cable plow VIPER V225, Frank Föckersperger offers a compact machine especially for plowing in fiber optic cables, power cables and cable protection pipes.

The new V225 is characterized by its robust design and easy operation.



A special feature is the **integrated tilt function**, which allows the complete frame to tilt hydraulically up to 10°.



The vibratory unit can be **swivelled hydraulically** and therefore allows plowing with lateral displacement.



V225 with track pads for protection of paved surfaces



The clear control unit and the **ergonomic driver's seat** allow comfort and convenience as well as maximum efficiency in daily work.

With its sophisticated features, the V225 makes it easy to plow in the most diverse ground conditions, helping to **increase productivity**.

TECHNICAL DATA

Vibratory Plow

| | |
|--------------------------------|--|
| Carrier vehicle and Cableplow | Föckersperger |
| Type | Viper® V225 |
| ENGINE POWER + WEIGHT | |
| Engine power | 168 kW / 225 HP Diesel |
| Weight | track version – 18.5 t wheel version – 16.5 t incl. laying blade and laying chute |
| DRIVE + CHASSIS | |
| Drive | hydrostatic drive |
| Chassis | with tilting function, 10° inclination adjustment |
| Drive (wheel/tracks) | track drive: D5H steel tracks, width 0.60 m wheel drive: all wheel, 2 steerable axles |
| VIBRATORY PLOW | |
| Vibration amplitude | continuously adjustable |
| Cable reel carrier | hydraulic reception, lifting capacity 3.5 t |
| Cableplow | laterally movable up to 1.50 m to the left and right |
| PRACTICE SPECIFICATIONS | |
| Laying depth | up to 1.50 m (depending on diameter and ground conditions) |
| Diameter of cable/pipe | up to Ø 125 mm (cable protection pipes, power cables, pipes) |
| Working speed | up to 5,000 m daily performance (depending on diameter and ground conditions) |

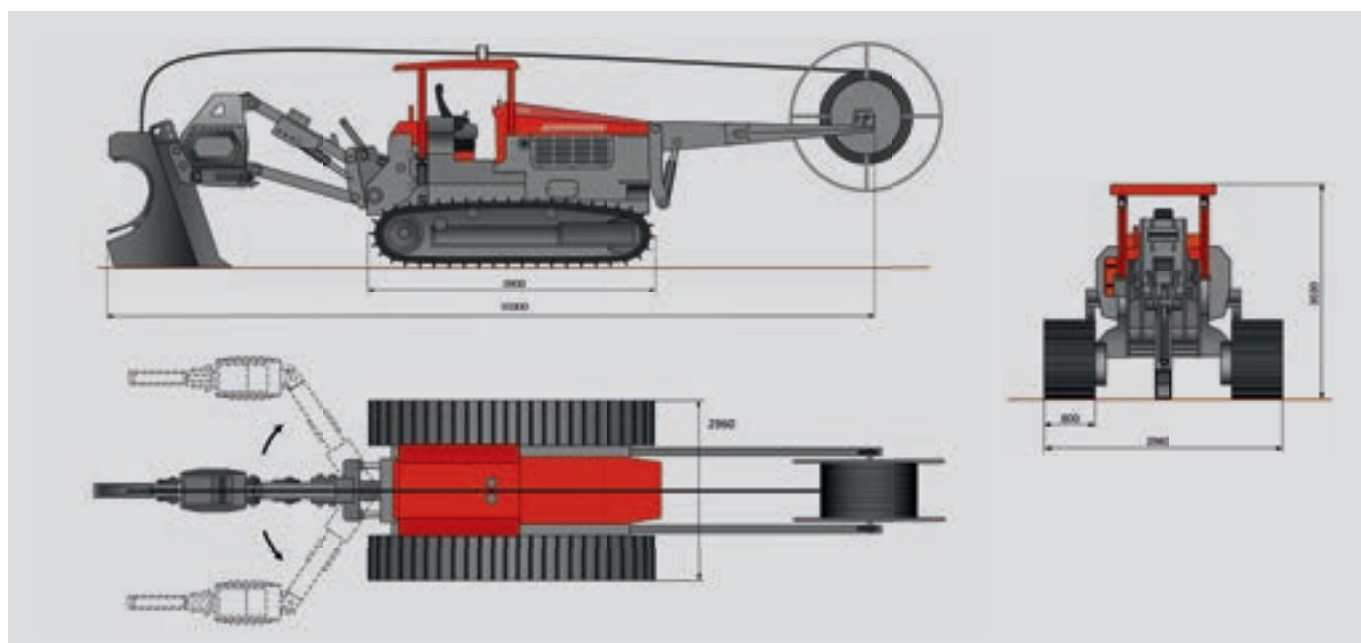

WINCHTRUCK F890

Cable winch works up to 160 tonnes tractive force

For towing Pipe and Cable Plows, e.g. on steep slopes, crossing brooks, in swampy areas, along railtracks, along paved roads, on embankments, cross-country, in almost every terrain.



The WinchTruck F890 carrier vehicle is available either on MAN or Mercedes chassis.

Both variants are equipped with the patented Frank Föckersperger winch construction.

All advantages at one glance

- Towing vehicle with road approval
- Short set-up and installation times
- Perfect hold (even on embankments)
- Swivelling winch construction
- Tipping and tilting support shield
- Minimum rope wear – optimal rope guidance



The swivelling of the frame, the tipping and tilting support shield and the single-drum winding guarantee maximum tractive force in every position.

TECHNICAL DATA

WinchTruck

| Type | WinchTruck F890 | WinchTruck F480 |
|------------------------------------|----------------------------|----------------------------|
| CARRIER VEHICLE | | |
| Carrier vehicle Mercedes | MB 4x4 EURO 6D | MB 4x4 EURO 6D |
| Carrier vehicle MAN | MAN 4x4 EURO 6D | MAN 4x4 EURO 6D |
| Max. speed | 86 km/h | 86 km/h |
| Ground clearance | 440 mm | 440 mm |
| ENGINE POWER + WEIGHT | | |
| Engine power | 375 kW / 510 HP | 375 kW / 510 HP |
| Weight | 18,000 kg | 15,000 kg |
| TYRE EQUIPMENT | | |
| Tyres | 16.00 R 20 XZL | 14.00 R 20 XCL |
| Tyre pressure control system | available on demand | available on demand |
| WINCH CONSTRUCTION | | |
| Tractive force – direct | 80 t | 40 t |
| Tractive force – deflection roller | 160 t | 80 t |
| Rope diameter | 44 mm | 36 mm |
| Rope length | 120 m | 100 m |
| Drive | hydrostatic | hydrostatic |
| Rope speed | stepless from 0 – 50 m/min | stepless from 0 – 25 m/min |
| Winch construction | hydraulically swivelling | – |
| Rope guidance | single-drum winding | – |

Hydraulically
swivelling
winch construction

Minimum cable wear
Single-drum winding
Optimal rope guidance

No additional
front and rear overhang



Hydraulically
tipping and tilting
support shield

Optimal 50:50
weight distribution

Up to 160 tonnes
tractive force

PIPE AND CABLE PLOW SPIDER F220

Pipe and cable plowing works in almost every terrain

The latest generation of the Frank Föckersperger Pipe and Cable Plow Spider is based on more than 50 years of practical experience.

The Frank Föckersperger Pipe and Cable Plow system is particularly well-suited for long overland routes and stands out for its flexibility, allowing it to be successfully used in a wide variety of terrains.



With the Pipe and Cable Plow Spider, flexible cables and pipes with an outer diameter of up to 500 mm can be easily and efficiently plowed in. Multiple cables and pressure pipelines can also be laid simultaneously – including warning tape.

**MADE IN GERMANY
MADE BY FÖCKERSPERGER**

Our specially developed machine technology incorporates many patented design solutions.

- Complete manufacturing at our company site in Aurachtal (Bavaria)
- More than 50 years of experience in cable plowing technology
- Practice-oriented advanced development
- Expert training
- Professional service



TECHNICAL DATA

Pipe and Cable Plow

| Type | Spider® F220 | Spider® F300 |
|--------------------------------------|---|---------------------------------|
| ENGINE POWER + WEIGHT | | |
| Engine power | 82 kW / 110 HP – Diesel | 140 kW / 190 HP – Diesel |
| Weight | 16,800 kg | 22,500 kg |
| TYRE EQUIPMENT | | |
| Tyres | 23.5 – 25 20 PR | 23.5 – 25 20 PR |
| MEASUREMENTS | | |
| Machine height | 3550 mm (incl. protective roof) | 3550 mm (incl. protective roof) |
| Transportation height | 4000 mm (incl. protective roof) | 4000 mm (incl. protective roof) |
| Curve radius | 3500 mm | 3500 mm |
| Ground clearance (wading depth) | 1600 mm | 1600 mm |
| Laying blade (from frame lower edge) | 2200 mm | 2500 mm |
| Laying blade optional | 2500 mm | 3500 mm |
| Height adjustment (embankment) | +/- 2000 mm (total 4000 mm) | +/- 2100 mm (total 4200 mm) |
| Slope angle (inclination) | 45° (100%) | 45° (100%) |
| Articulation angle (main frame) | +/- 30° | +/- 30° |
| Swivel angle (plow arms) | 38° | 38° |
| PRACTICE SPECIFICATIONS | | |
| Max. tractive force | 160 t | 280 t |
| Max. running speed | 8 km/h | 8 km/h |
| ADDITIONAL EQUIPMENT | | |
| | Telescopic arms Comfort cabin with heating and aircondition Digital depth display | |

Wheel suspension
on top for optimal
ground clearance

Two-part laying blade
for optimal depth and
terrain adjustment

Protective roof
hydraulically
height adjustable



Powerful 4 x 4
propulsion technology
with differential lock

Traction force point
directly in front of
the laying blade

Weight optimized
and perfect weight
distribution

ALL ADVANTAGES AT ONE GLANCE

1 flexible and powerful!

- plowing and cable / pipe installation in one go
- cost savings of 50 % or more compared to open trenching
- high daily performance, up to 5,000 m possible
- short setup and construction times
- high installation quality

2 environmentally friendly!

- no mixing of soil
- minimal traffic disturbance
- minimal working area
- no topsoil removal
- any traces of work disappear quickly after installation

3 increases productivity!

- optimal adaptation to every kind of terrain and constant laying depth
- cost savings through shorter construction times compared to open trenching
- practice-oriented advanced development
- more than 50 years of experience in production, development and application of the method
- enormous flexibility for varying application conditions

**PLOWING IN OF
FIBER OPTIC CABLES
POWER CABLES
CABLE PROTECTION PIPES
DRINKING WATER
SEWER AND GAS LINES**

Digital depth display



PIPE AND CABLE PLOW METHOD – SYSTEM DESCRIPTION

for cables and pipes up to Ø 500 mm

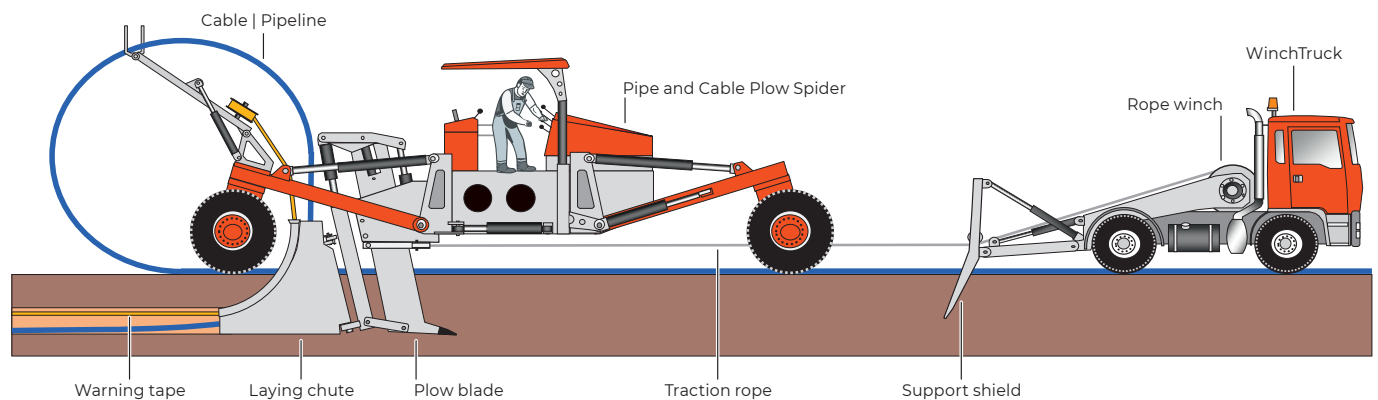

The Cable Plow is pulled by a WinchTruck equipped with a rope winch. The truck anchors itself firmly into the ground with a support blade, enabling it to generate a pulling force of up to 160 tons. To adapt seamlessly to uneven terrain, the Cable Plow is equipped with four individually adjustable plow arms and hydraulically controlled wheels.

At the beginning of the process, the plow blade is placed into a starting pit at the desired laying depth. As it is pulled forward, it displaces soil and stones in the cable trench, while the movable laying chute smooths the trench bottom. This creates a hollow space where the cables are laid stress-free at the specified depth. The Cable Plow can plow in multiple cables and warning tapes in a single operation.

Installation materials

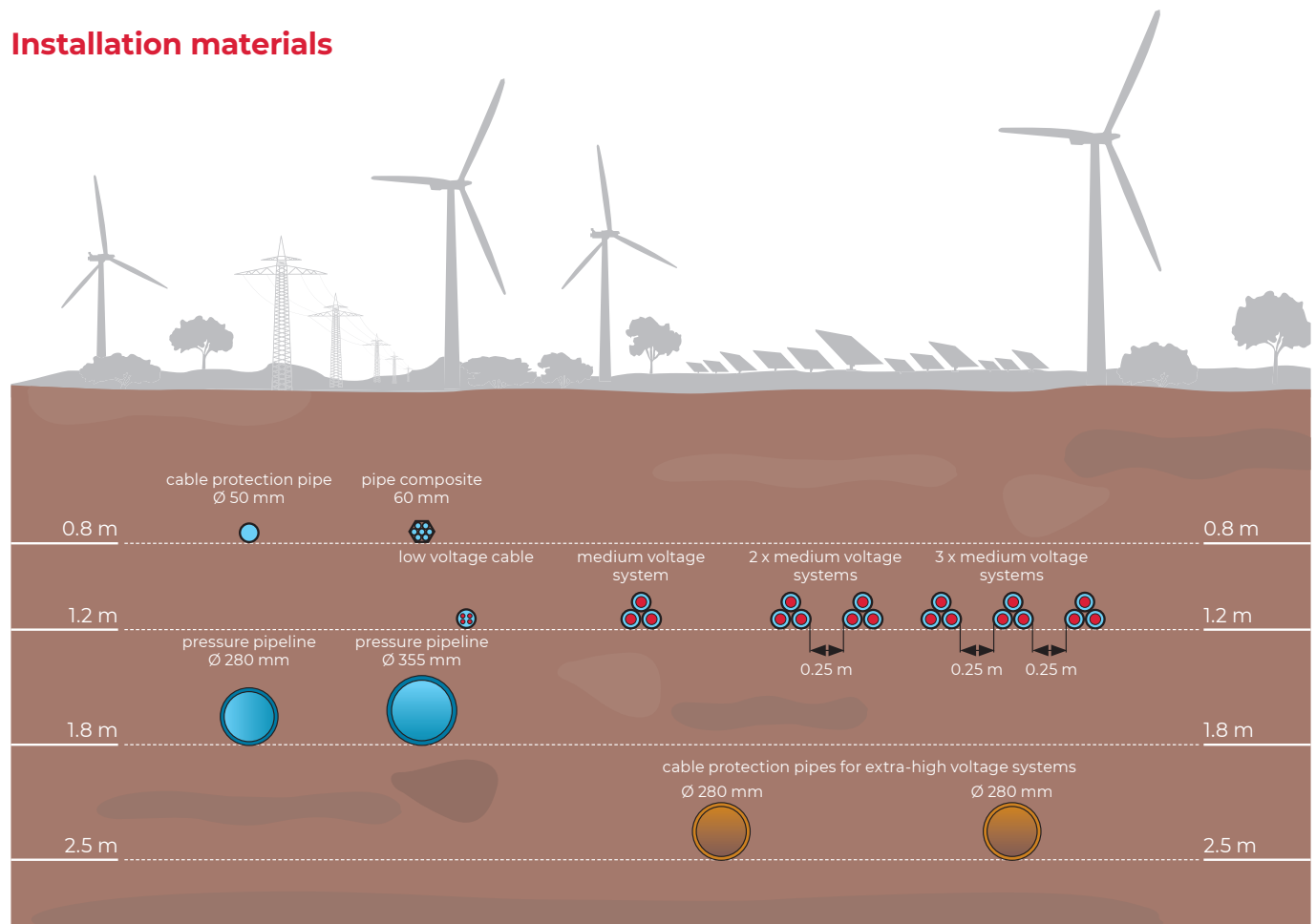

LAYING CHUTES

We manufacture laying chutes for the Pipe and Cable Plow Spider and the Vibratory Plow Viper. The practical design and precise construction ensure a smooth passage of cables and pipes through the laying chute, making the plowing of cables, cable protection pipes and pipelines with an outer diameter of up to 500 mm effortless and most efficient.

Custom sizes, special designs and solutions are available upon request.



Laying chute 70
plowing in of cables and
pipes up to Ø 70 mm

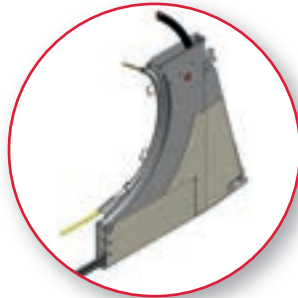

Laying chute 110
plowing in of cables and
pipes up to Ø 110 mm
(typical 20kV duct)



Laying chute 150
plowing in of cables and
pipes up to Ø 140 mm

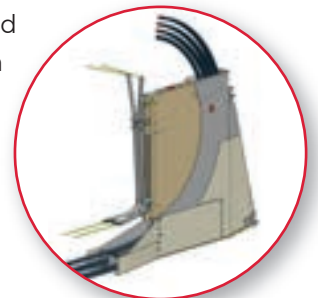

Laying chute 2x 20 kV
plowing in of 2 x 20 kV
medium-voltage systems

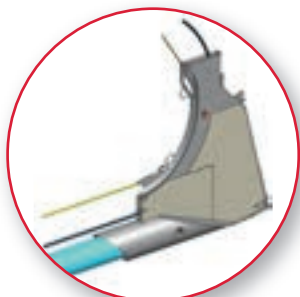

Rocket chute 500
plowing in of pipes
up to Ø 500 mm

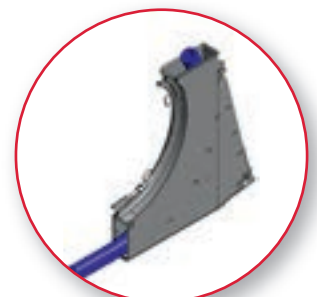

Laying chute 200
plowing in of pipes
up to Ø 180 mm



Laying chute 380
plowing in of pipes
up to Ø 355 mm

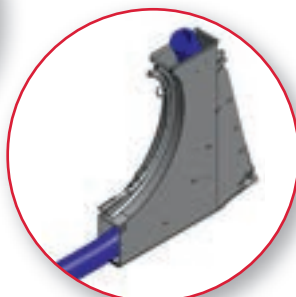

Laying chute 270
plowing in of pipes
up to Ø 250 mm

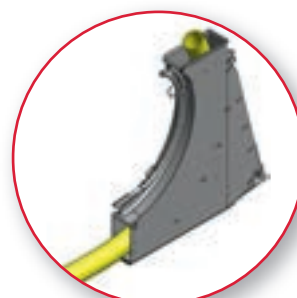

Laying chute 240
plowing in of pipes
up to Ø 225 mm

CABLE TRAILER F318

The professional solution for a safe transport of up to three cable drums, each up to 2.80 m in diameter and 2.10 m in width.

The cable trailer F318 can collect up to three cable drums. The cables can be plowed in directly through the Cable Plow or can be alternatively pre-positioned along the route.



CABLE DRUM RACK CDR280

Mount our cable drum rack on your own trailer!

Secure hold and transport of one or more cable drums, each up to 2.80 m in diameter and 2.10 m in width, equipped with the proven Föckersperger safety system.

Equipment

- cable drum rack
- safety shaft suspension with self-guidance and crane shackle
- shaft Ø 70 mm
- stepped bushings
- clamping shells
- lashing eyes



Option: Rail frame for individual positioning of up to three cable drum racks on the trailer.



DECADES OF EXPERIENCE AND INNOVATION

- | | |
|------|---|
| 1865 | Johann Heinrich Müller founded a business in Münchaurach for mill repairs, laying the foundation for the company's history. |
| 1970 | Georg Föckersperger began developing, designing and manufacturing the first Pipe and Cable Plow as well as the first WinchTruck. |
| 1988 | Introduction of CNC technology and expansion into precision part manufacturing for in-house machines, industry and motorsports. |
| 2005 | As part of the company succession, Georg Föckersperger GmbH was split into Günter Föckersperger GmbH for the CNC manufacturing and Frank Föckersperger GmbH for the area Cable Plow. |
| 2008 | Foundation of the subsidiary Föckersperger Maschinen GmbH for the distribution of in-house developed Pipe and Cable Plow systems. |
| 2011 | Introduction of the WinchTruck F780 and the Pipe and Cable Plow Spider F220. |
| 2014 | Development of the largest and most powerful Pipe and Cable Plow Spider F250. |
| 2015 | 150th company anniversary. |
| 2016 | Market launch of the Vibratory Plow Viper V225 on tracks. |
| 2017 | Foundation of Föckersperger FST GmbH for full-service Pipe and Cable plowing as well as complete underground utility projects. |
| 2019 | Market launch of the Vibratory Plow Viper V225 on wheels. |
| 2021 | Completion of a three-year research project on "Minimally invasive and soil-conserving cable plowing technology for parallel installation of ultra-high voltage cables," in collaboration with the German Federal Ministry for Economic Affairs and Climate Protection. |
| 2023 | First official cable plowing operation for ultra-high voltage lines. |
| 2024 | Development of the latest generation of the most powerful and adaptable Pipe and Cable Plow Spider. |

General manager Sales manager



Frank Föckersperger



Michael Jahn

**Please contact us –
we will be pleased to assist you!**



Föckersperger Maschinen GmbH

Wirtshöhe 2 · 91086 Aurachtal-Münchaurach
Germany



+49 (0)9132 7844-50

www.foeckersperger.com

FÖCKERSPERGER

